

## Prefiltration or clarification felt bag, assuring economical nominal filtration.



### Conditions of use

Max pressure loss	2,4 bar
Recommended replacement differential pressure	0,7 - 1,4 bar
Max flow rate	20 m <sup>3</sup> /h (size 10)

### Description

QUALIPOCHE F bags are made from fibers that allow for decreasing porosity. The needle felt gives the bag a good retention capacity with minimal pressure drop. The surface of the felt retains coarse impurities and its internal structure ensures retention of finer particles.

The wide range of filter materials offers excellent chemical compatibility for a variety of industrial applications.

The bags are also available in a thicker version (PP and Polyester) which significantly increases performance and service life.

### Characteristics & benefits

- Porosity wide range from 1 to 200 µm.
- Standard or custom bag.
- W shaped bag available enabling a 60% increase in filtration area.
- Wide range of filtration media : polypropylene (PP), polyester (PES), Nylon, polytetrafluoroethylene (PTFE).
- Thick felt design available for increased retention capacity and life span : PP and PES.
- External surface with thermal treatment to prevent leaching.
- Woven handle on the bags with retaining ring for a better grip.
- Complies with EU 1935/2004, EU 10/2011 and its amendments, EU 2023/2006 and complies with FDA regulations according to 21 CFR parts 177-1520 and 176-170 (in IW code).
- Molded rings complete with integral lifting handles.
- Made from silicone-free materials.
- Lot number on bags and packaging.

### Chemical compatibility

	Polypropylene	Polyester	PTFE	Nomex®
Alkaline	+++	-	+++	+++
Acid	+++	+++	+++	+
Oxidizer	-	+++	+++	+
Solvent	+	++	+++	+++
Tmax (°C)	90	140	260	200

+++ Excellent | ++ Good | + Fair | - Not compatible

Note: displayed temperatures are only applicable for metal rings. If polypropylene ring, do not go above 90°C.

## ORDER REFERENCE

Example :

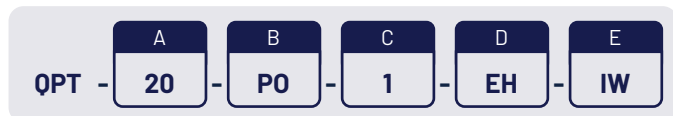

## A / Size

Code	Diameter (mm)	Length (mm)	Volume (liters)	Area (dm <sup>2</sup> )
10	180	450	10	26
10W	180	450	5	40
20	180	820	19	44
20W	180	820	10	70
30	260	860	42	65
40	260	1070	53	85
03	95	230	1.1	6
04	107	230	1.2	8
05	110	230	1.3	9
07	95	385	2.3	11
08	107	385	2.8	12
09	110	385	3.2	14
x100	152	510	5.6	18
BB10	107	218	1.1	6
BB20	107	457	3.8	15

## B / Media

Code	Material
PE	Polyester felt
PO	Polypropylene felt
PT	PTFE felt
NX	Nomex® felt [aramid]

## C / Retention threshold

Code	Porosity	PE	PO	PT	NX
1	1 µm	•	•		
5	5 µm	•	•	•	
10	10 µm	•	•		
25	25 µm	•	•		•
50	50 µm	•	•		
100	100 µm	•	•		
200	200 µm	•	•		

## D / Ring

Code	O-ring	Available sizes
EH	Galvanized steel	All
S	Stainless steel	All
P	Polypropylene	All

Code	Molded ring	Available sizes
ERP	Profile 1 [PP]	10 / 20
ERS	Profile 1 [PES]	10 / 20
PR	Profile 1 [Santoprene™]	10 / 20
EFS	Profile 2 [PP]	10 / 20 / 04 / 08
EFSE	Profile 2 [PES]	10 / 20 / 04 / 08
X10P	Profile 3 [PP]	X100
EAP	Profile 4 [PP]	10 / 20
EAPE	Profile 4 [PES]	10 / 20
EAS	Profile 4 [Santoprene™]	10 / 20

## E / Options

Code	Description
IW	Indicates that the bags are wrapped individually. If not mentioned, bags are wrapped in batches.
LG	Standard filter bags with increased length.
SE	Stitched side / bottom ; welded plastic ring.

### PROFILE 1

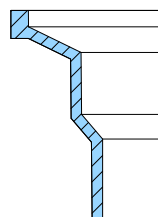

### PROFILE 2

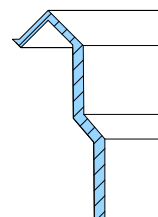

### PROFILE 3

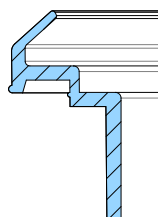
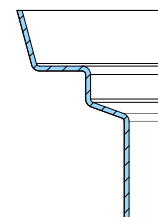

### PROFILE 4

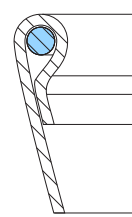

### O-RING

