

EN Data sheet

Low flow filter on one or two filtration tanks



FILTER MEDIA

Standard cartridge:

- MC15 : 1 x 10" cartridge
- MC15 parallel: 2 x 10" or 20" cartridges
- MC15 serial: 2 x 10" or 20" cartridges
- MC15 PVDF: 1 x 10" cartridge
- MC15 parallel PVDF: 2 x 10" cartridges



ADVANTAGES

- Automatic vent.
- Excellent resistance to acids and bases thanks to injected polypropylene or PVDF.
- Welded tank, no gaskets, no risk of leakage.
- Side panels protecting the pump from splashes.
- Quick opening lid.
- Assembly in series or parallel.
- Double tank version (MC 15 2x10).

SPECIFICATION

Performances	
Max flow rate (m ³ /h)	1,5 -> 4
Max temperature (°C)	80 (PP) - 110 (PVDF)
Filtration fineness (µm)	0,5 -> 150
Motor	
Maximum power (W)	180
Design	
Technology	Magnetic drive
Available materials	Polypropylene (PP) Polyvinylidene fluoride (PVDF)
Seals	EPDM - FPM
Pumps	M15 - M35 - M50
Connection	Grooved nozzle, Union nut, Flanges

MC15 FLOW RATE CHARTS

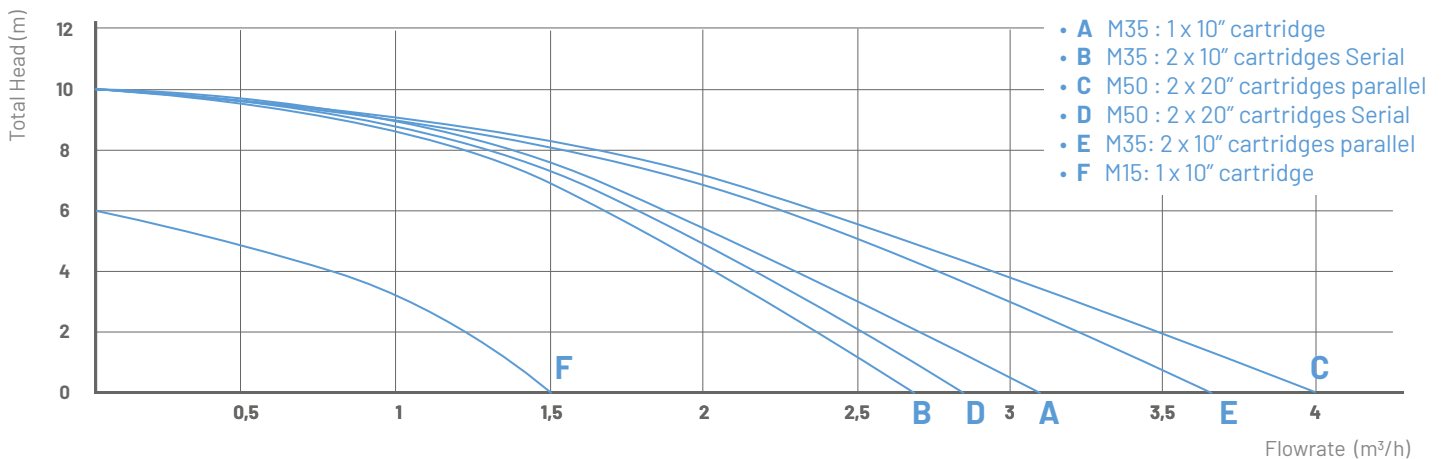

**DIMENSIONS
MC15 - M15**

Units : mm

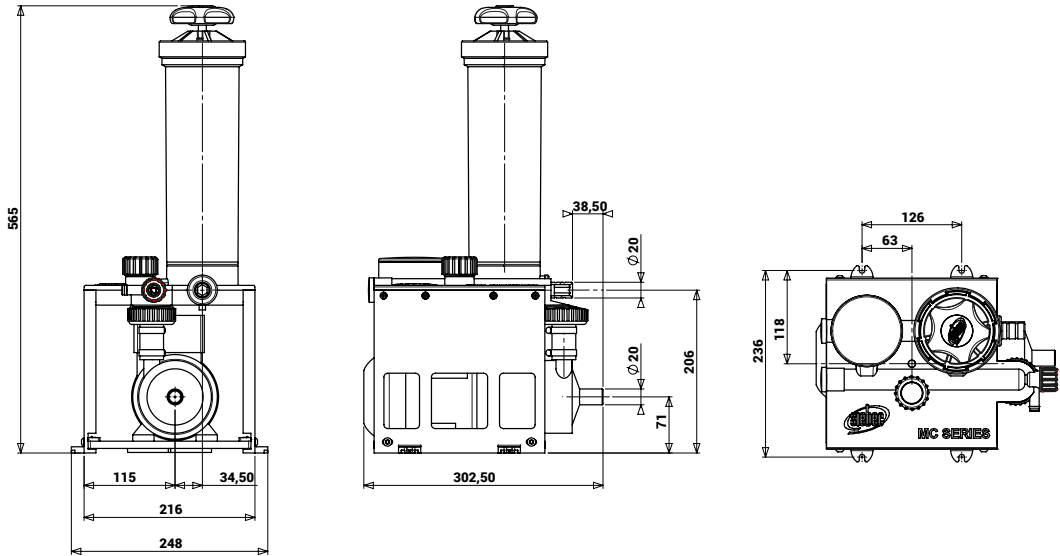

**DIMENSIONS
MC15 - M35 / M50**

Units : mm

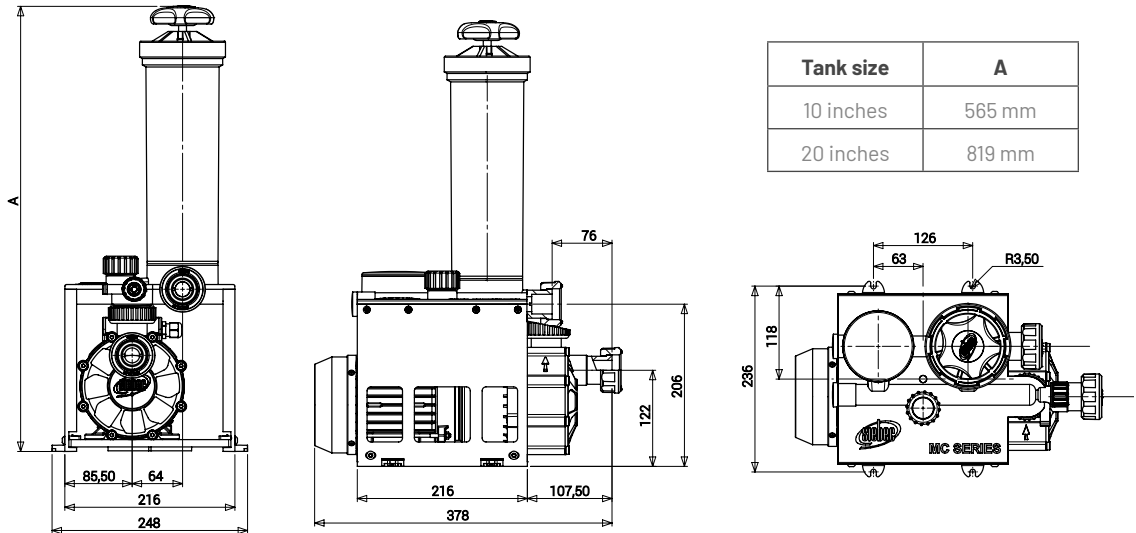

Tank size	A
10 inches	565 mm
20 inches	819 mm

**CONNEXIONS
M35 / M50**

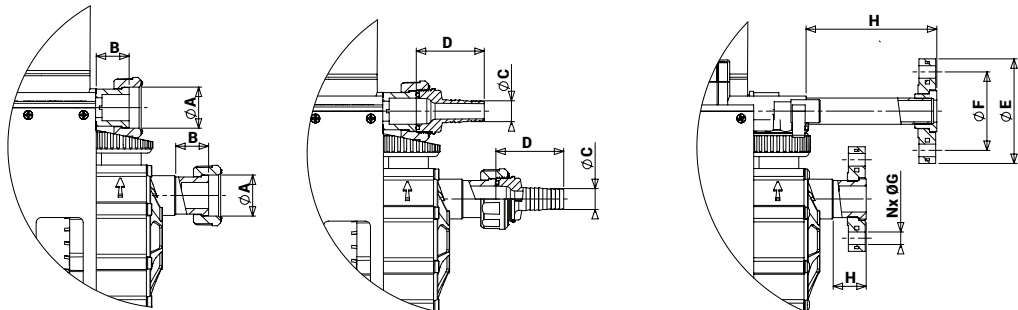

		UNION NUT DA - B		Grooved nozzle DC - D		Flanges DE - DF - Nx ØG - H			
M35	Input	G1"1/2 - DN20	31,5	Ø20	50	Ø115	Ø85	4 x Ø14	31,5
	Output	G1"1/2 - DN20	31,5	Ø20	50	Ø115	Ø85	4 x Ø14	175
M50	Input	G1"1/4 - DN25	31,5	Ø25	50	Ø100	Ø75	4 x Ø12	31,5
	Output	G1"1/4 - DN25	31,5	Ø25	50	Ø100	Ø75	4 x Ø12	175

